

Safety & Installation Instructions

These instructions are provided for your safety in order to prevent the risk of Fire, Electric shock or Injury. It is vitally important that they are read in their entirety before installing your fitting. Please retain for future reference.

If you are in any doubt consult a qualified electrician as to the installation of the fitting.

1. Position the light where desired ensuring that there is a plug socket within easy access of the fitting and the wall is suitable for supporting the weight of the fitting (5kg). Before making any holes, confirm that there are no hidden electrical wires or pipes in the chosen location, that could be damaged.
2. Mark position of fixing holes, before drilling appropriate holes as below.
 - a. Brick or masonry: Drill holes into which the wall plugs tightly fit, then insert wall plugs.
 - b. Wood: No hole necessary (unless small pilot hole required), screws can be screwed directly into the timber.
 - c. Plaster/Cavity: Special cavity wall fittings are required, rather than provided fixings. These are widely available from good hardware or DIY store and should come with their own instructions that must be followed. It may be easier to relocate the fitting so that you screw directly into a timber joist or beam.

Safety Instructions

These instructions are provided for your safety in order to prevent the risk of Fire, Electric shock or Injury. Please retain for future reference. When fitting is in operation, some parts will become hot; take care when using/handling.

- Ensure the lamp type and max wattage is followed- do not exceed. Take care not to overtighten lamp.
- Do not touch the lamp (bulb) or lamp holder while in operation, as both become very hot.
- Turn off and unplug fitting, leaving lamp to cool before changing lamp. Dispose of old lamps carefully.
- Adjust light fitting only when power to the fitting is off and has been left to cool.
- Never leave a fitting without a lamp in position.
- Keep light fitting away from combustible materials such as soft furnishings.
- Ensure children do not play with the light fitting.
- If the electrical flex or electrical components become damaged at any point, the fitting must be unplugged from the power supply immediately and not operated until the damaged parts are fixed/replaced.
- For use in a dry, indoor environment only. Ensure the fitting does not come into contact with any liquids.

Cleaning and Maintenance

Metal finishes should only be cleaned with a soft, dry cloth. Do not use polishes or abrasives. Bone china can be cleaned by hand, using a soft damp cloth with a diluted mild detergent (nonabrasive) if necessary. Switch off power to the fitting before cleaning.

Hatton 4 Wall Light

Instruction Manual

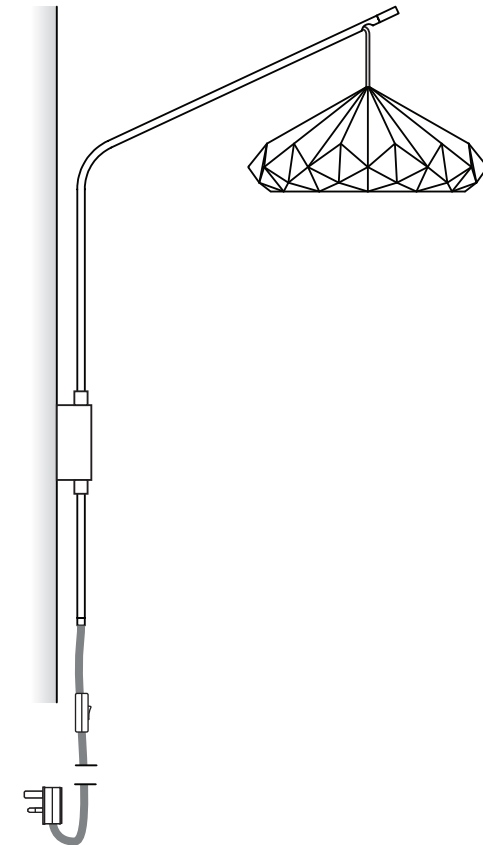

Established in 1990, Original BTC manufactures relaxed, familiar lighting for traditional and contemporary homes.

All products are hand-assembled in Oxford from high quality components, produced in the UK.

ORIGINALBTC.COM

+44 (0)1993 882 251

UNIT 21 / 22 AVENUE ONE, STATION LANE, WITNEY, OX28 4XZ, ENGLAND



ORIGINAL BTC

BRITISH LIGHTING MANUFACTURERS
LONDON - NEW YORK - PARIS







Hatton 4 Wall Light

| 230V ac 50Hz | IP20

FW565

The Hatton 4 Wall Light has an intricately made, multifaceted bone china shade. When lit the translucent shade provides an exquisite, warm light.

LAMP GUIDANCE			
BASE	SHAPE	TYPE*	WATTAGE**
		INCANDESCENT ✓	100W MAX
		CFL ✓	18W
		ECO-HALOGEN ✓	70W
		LED ✓	12W

* Warm white (2700k) low energy lamps recommended.
 ** Wattage value provided as a guide to suitable lamps. Lower wattage than stated may be used.

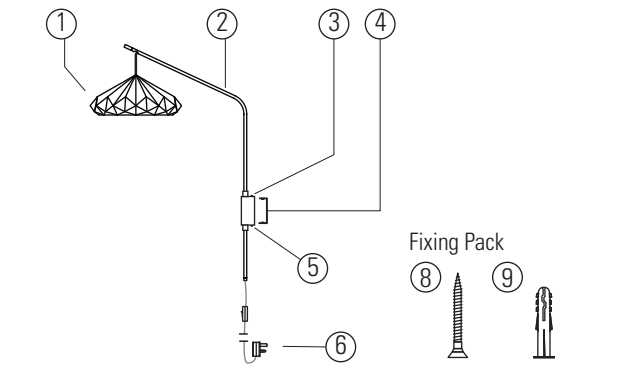

- Contents**
- 1 - Shade
 - 2 - Arm
 - 3 - Fixing screw
 - 4 - Wall bracket
 - 5 - Back box
 - 6 - Plug
 - 7 - Wall screws
 - 8 - Rawl Plugs
- Required for Installation**
- Screwdriver, flat-head
 - Hex Key size 3
 - Small screwdriver, flat-head
 - Drill (if holes are required)

PLEASE READ THE INSTRUCTIONS ON THE REVERSE BEFORE YOU BEGIN INSTALLING YOUR LIGHT

Installation and Assembly Instructions

Refer to diagrams on opposite page.

STEP 1

Remove the wall bracket from the back box by undoing the two dome head screws using a hex key. Mark fixing holes through fixing bracket before drilling holes, see point 1 & 2 on reverse. Ensure holes will result in the backplate being straight, then screw fixing bracket to the wall, ensuring fitting is securely fixed to the wall.

STEP 2

Slide the backbox over the wall bracket, aligning the two holes top and bottom. Secure in place using the two dome head hex screws.

Installation Diagram

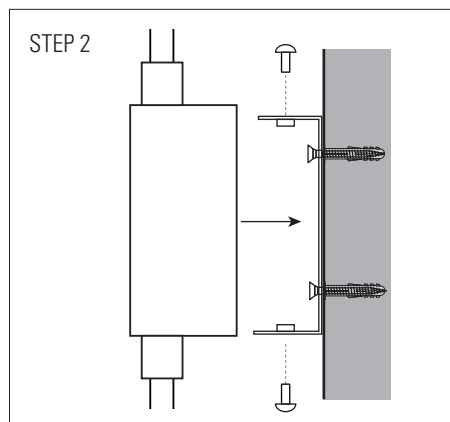
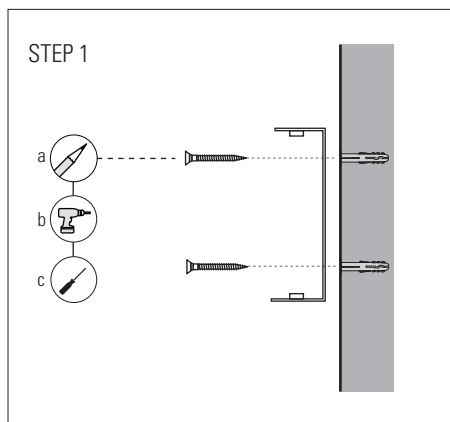

Setting the Cable Length

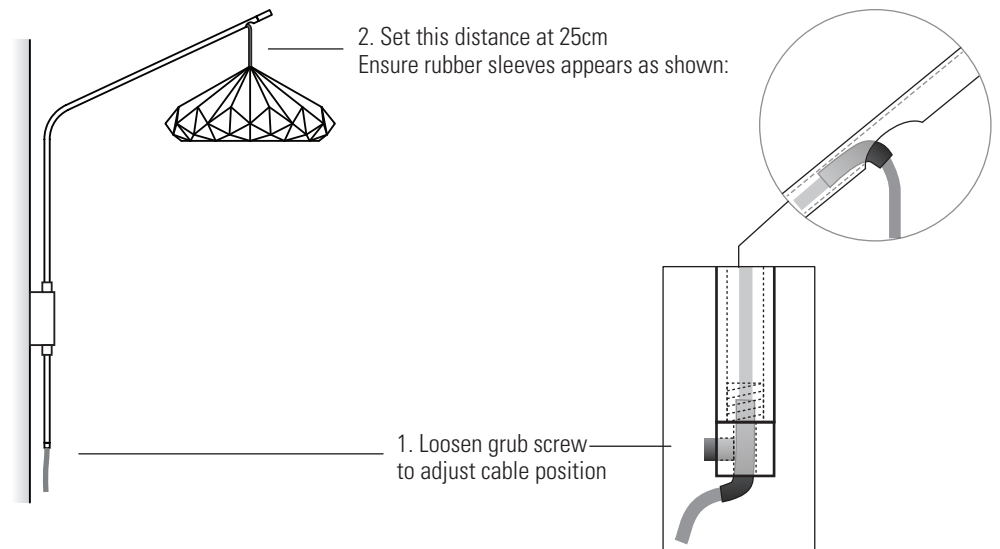

Adjusting the fitting

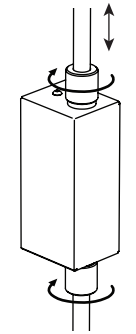

To change the position of the arm or rotate it, loosen both the knurled grips on the wall box by rotating them anti clockwise, whilst supporting the arm.

Move the arm to the desired position and retighten both of the grips so that the arm is held securely in place.